



MODEL -

PLAN

# OUR RAISED BED GARDEN 14 ea. 3' X 12' RAISED BEDS BUILT IN 2019.

**Notes:**

1. Timers AC vs DC would like to use a small solar panel and DC controller  
DIG LEIT Solar Timer with 3/4" Valve SKU: TDLT34 (fittings - ??) What connects to the two threaded ends?
2. Support Stakes
3. 1/2" Easy Loc Coupler With Valve
4. Screen Washers

## Raised Beds



40' Hugelkultur Bed on North Hill Above This Row Of Raised Beds



PSI regulator  
hose filter  
Start fitting  
1/2" main line

## Existing 1,200 gal above ground rain water tank

Rotoplas Model 1,200 GAL ABOVE GRADE PLASTIC TANK

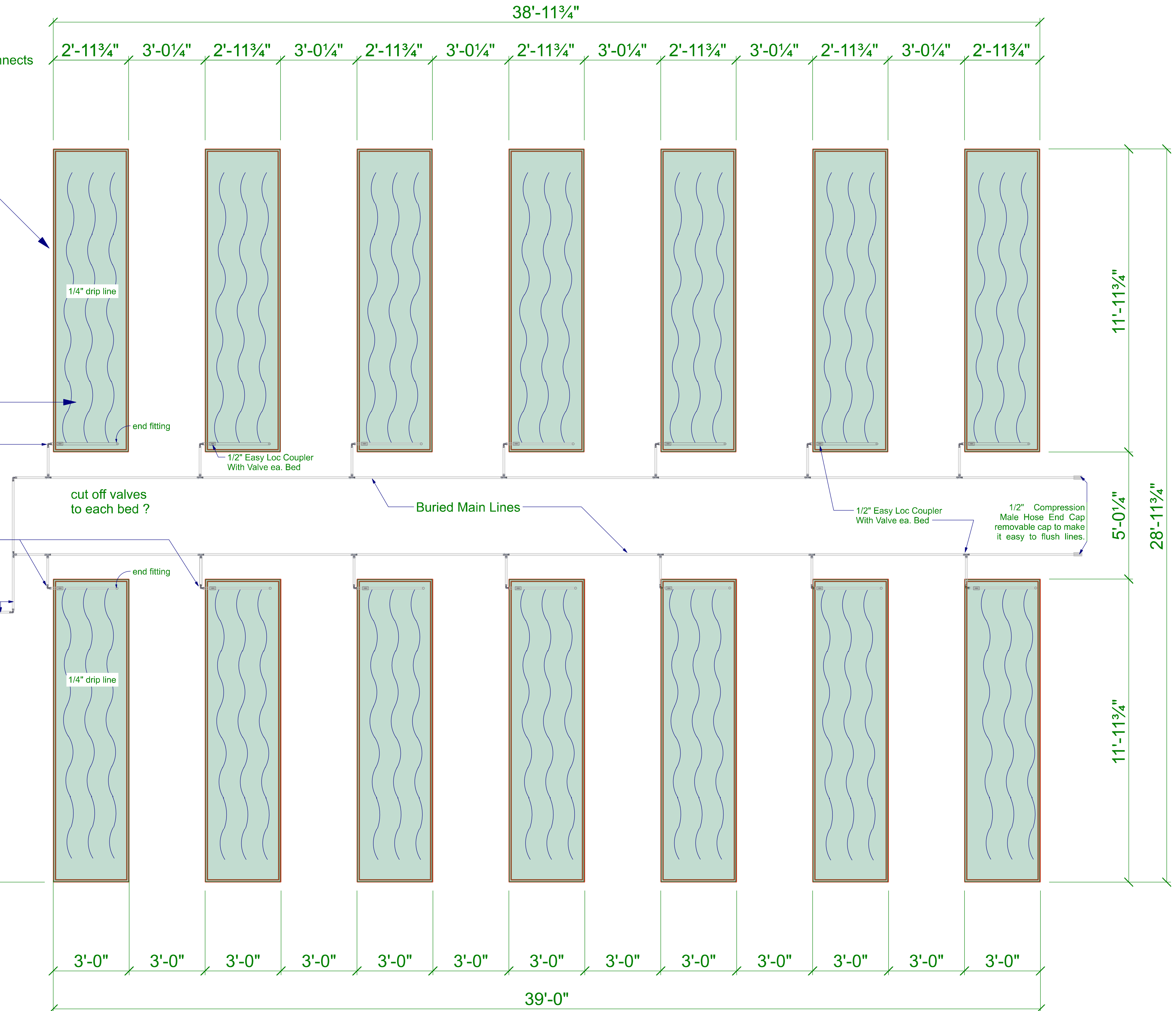
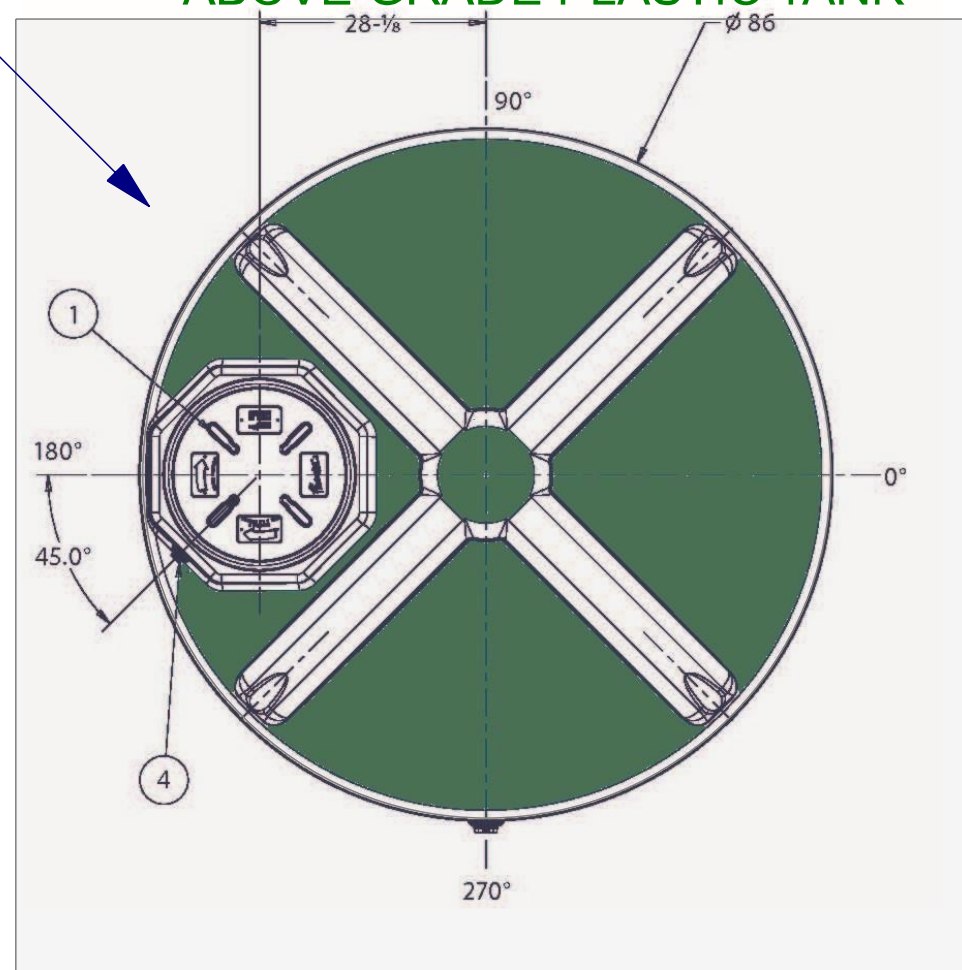

MODEL - PLAN

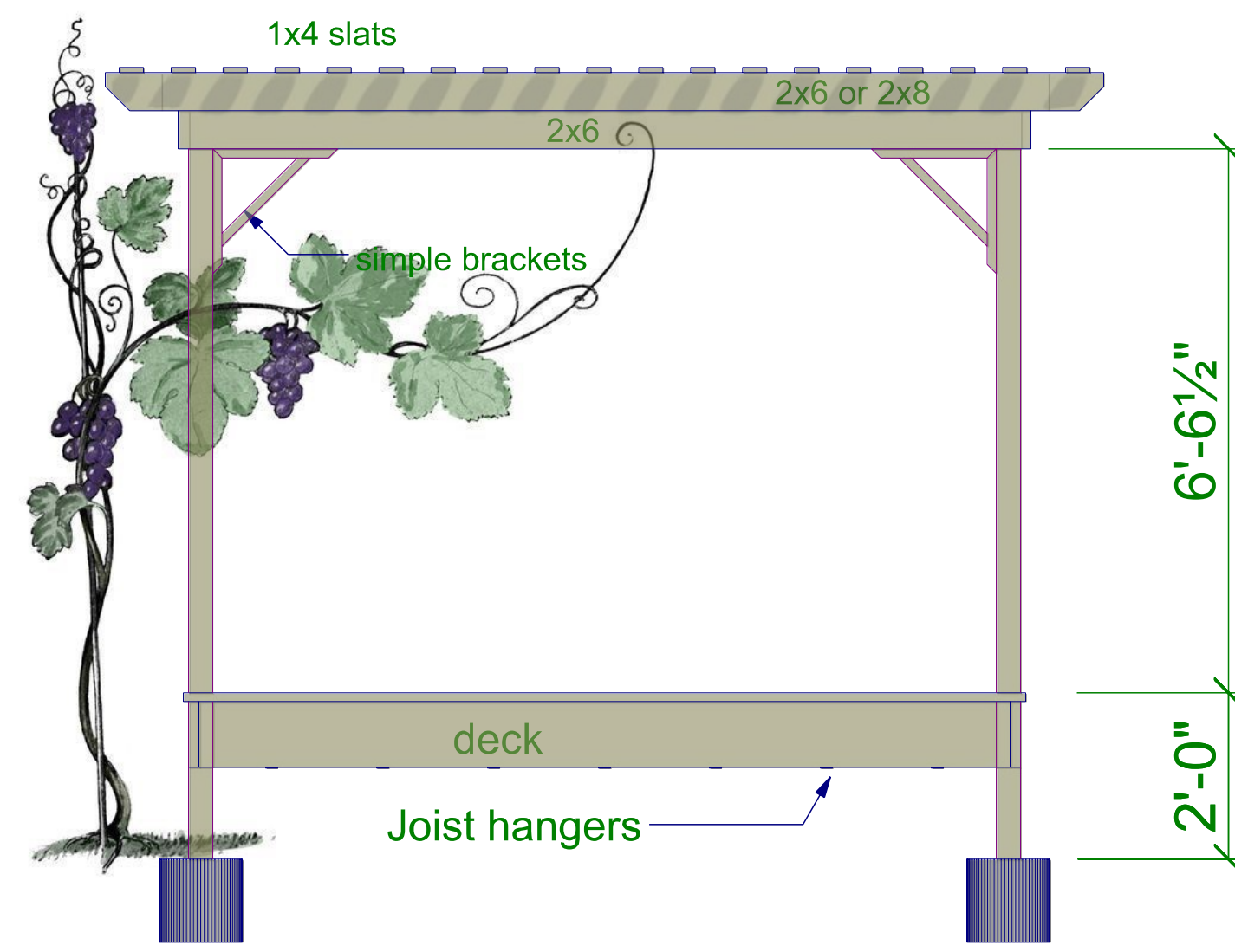

**SOUTH ELEVATION**  
SCALE: 1/2" = 1'-0"

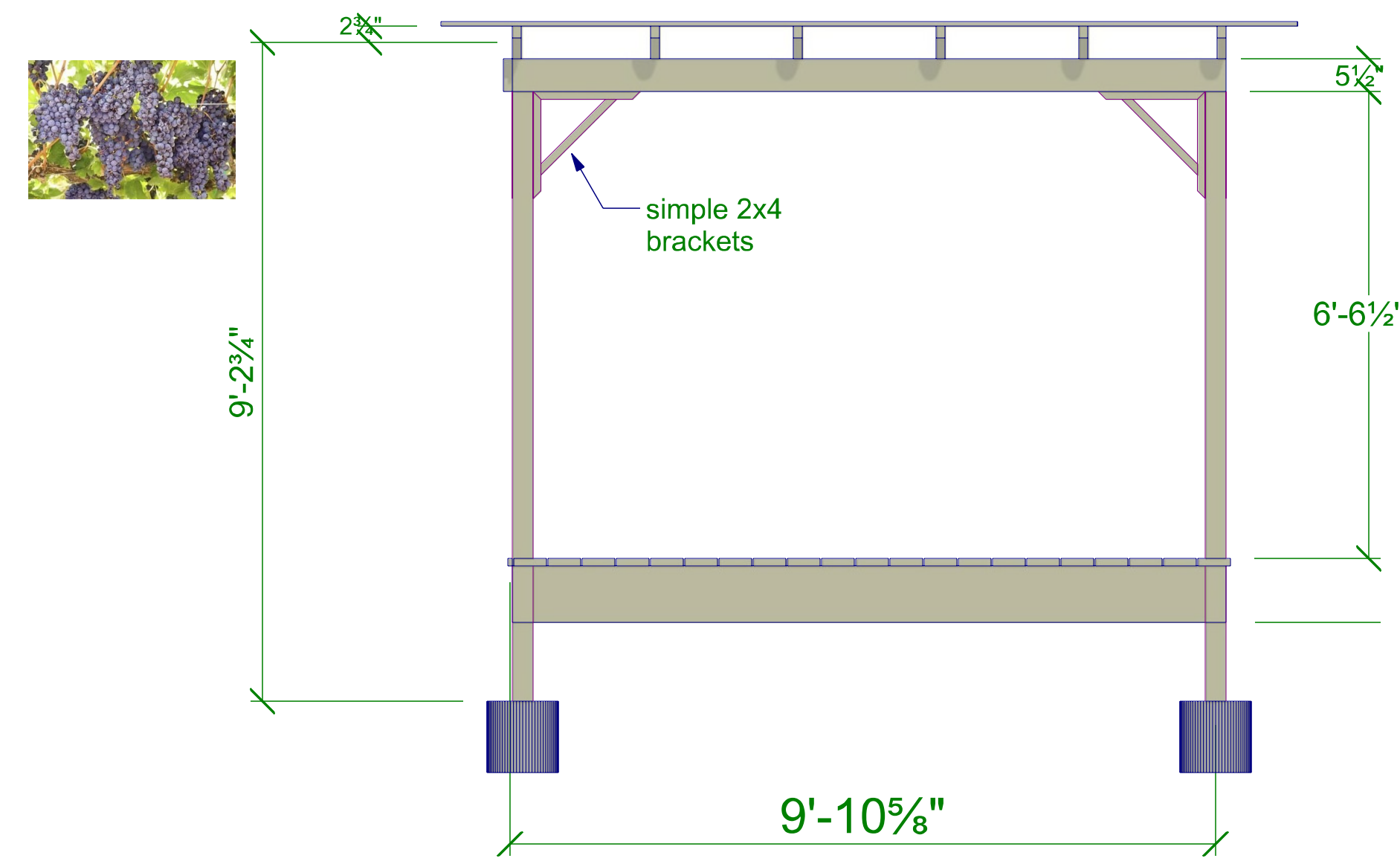

**WEST ELEVATION**  
SCALE: 1/2" = 1'-0"

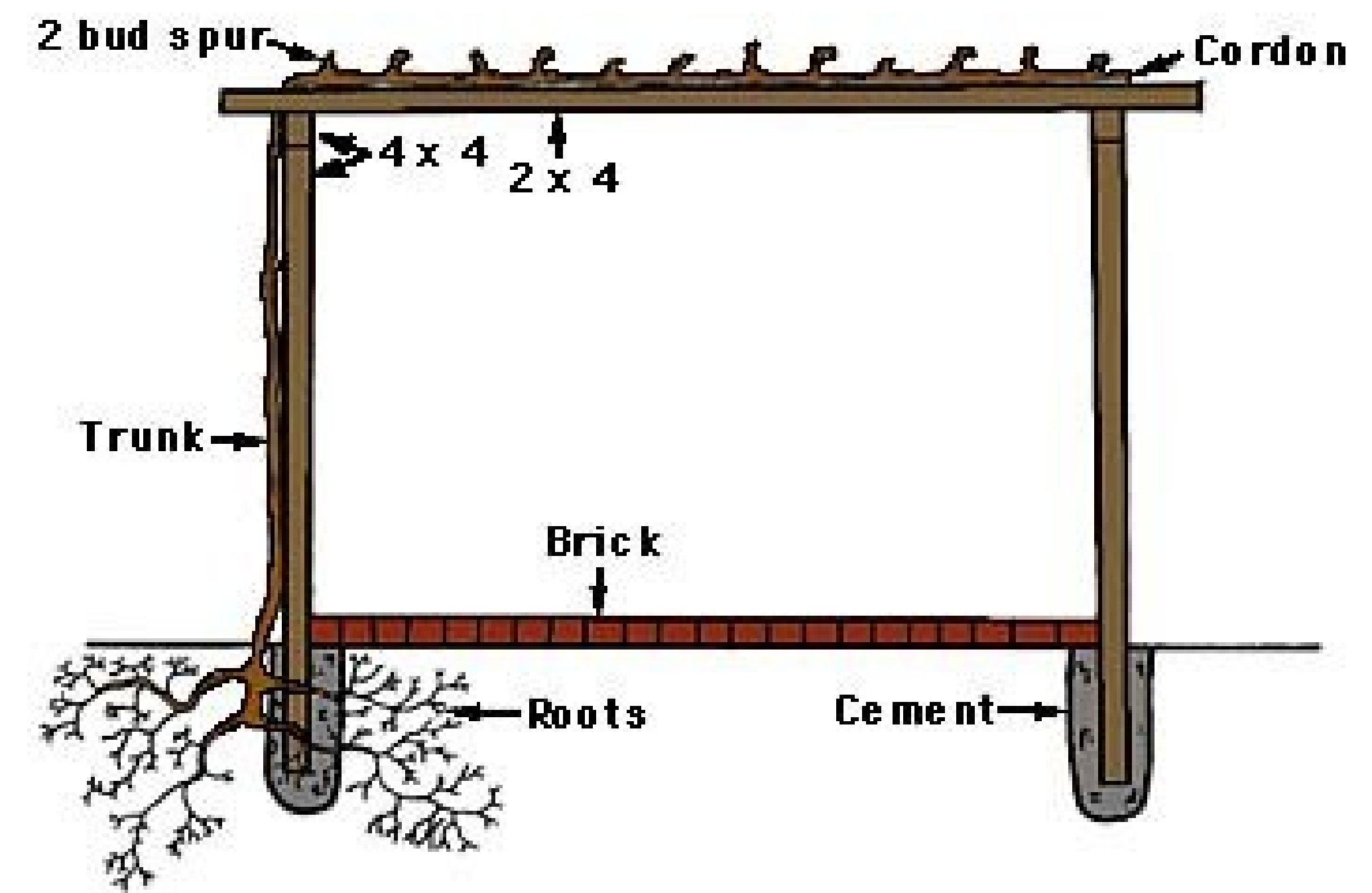

**Figure 4. An end view of a grape arbor with a dormant mature vine pruned to an arbor cordon.**

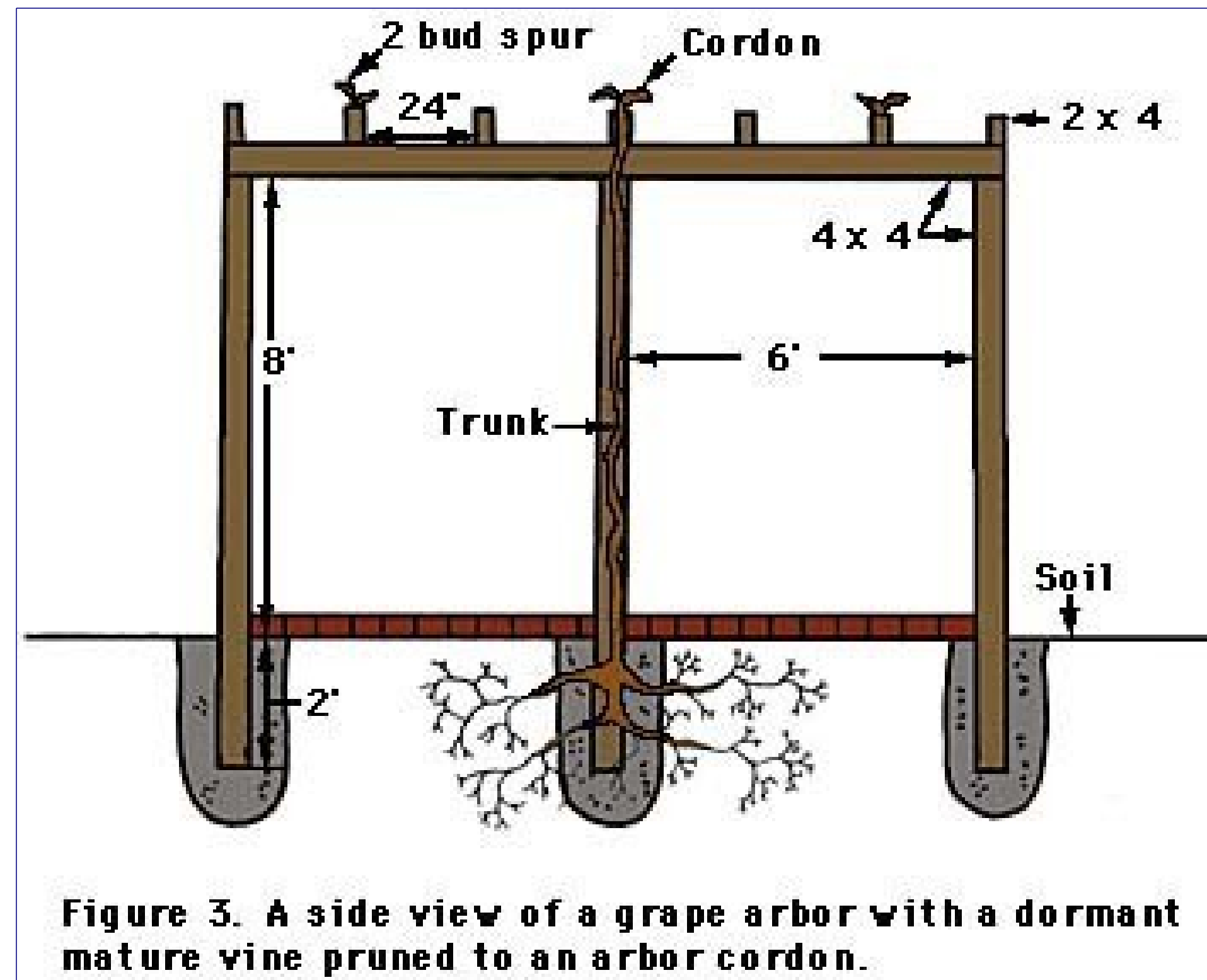
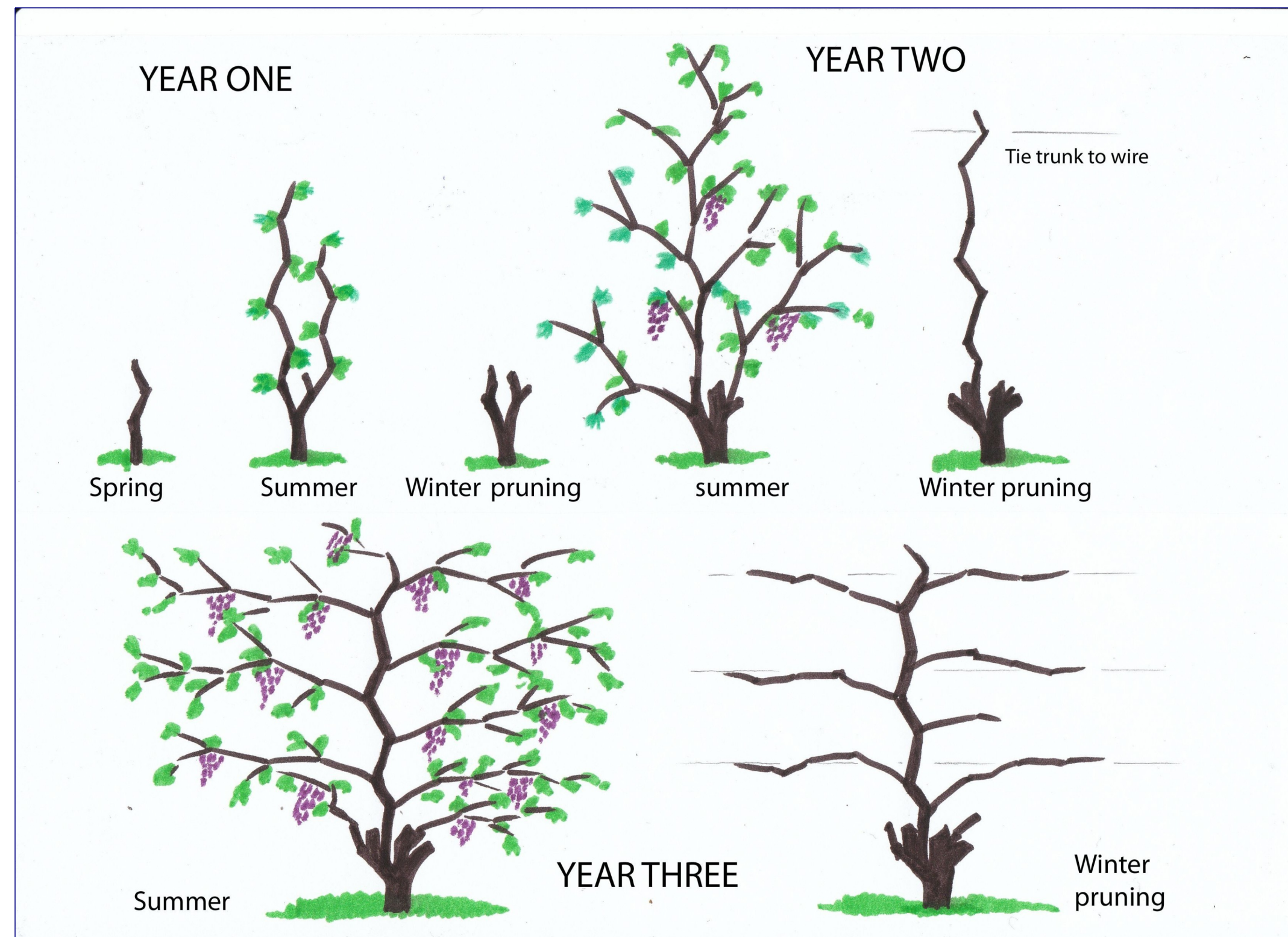

**Figure 3. A side view of a grape arbor with a dormant mature vine pruned to an arbor cordon.**

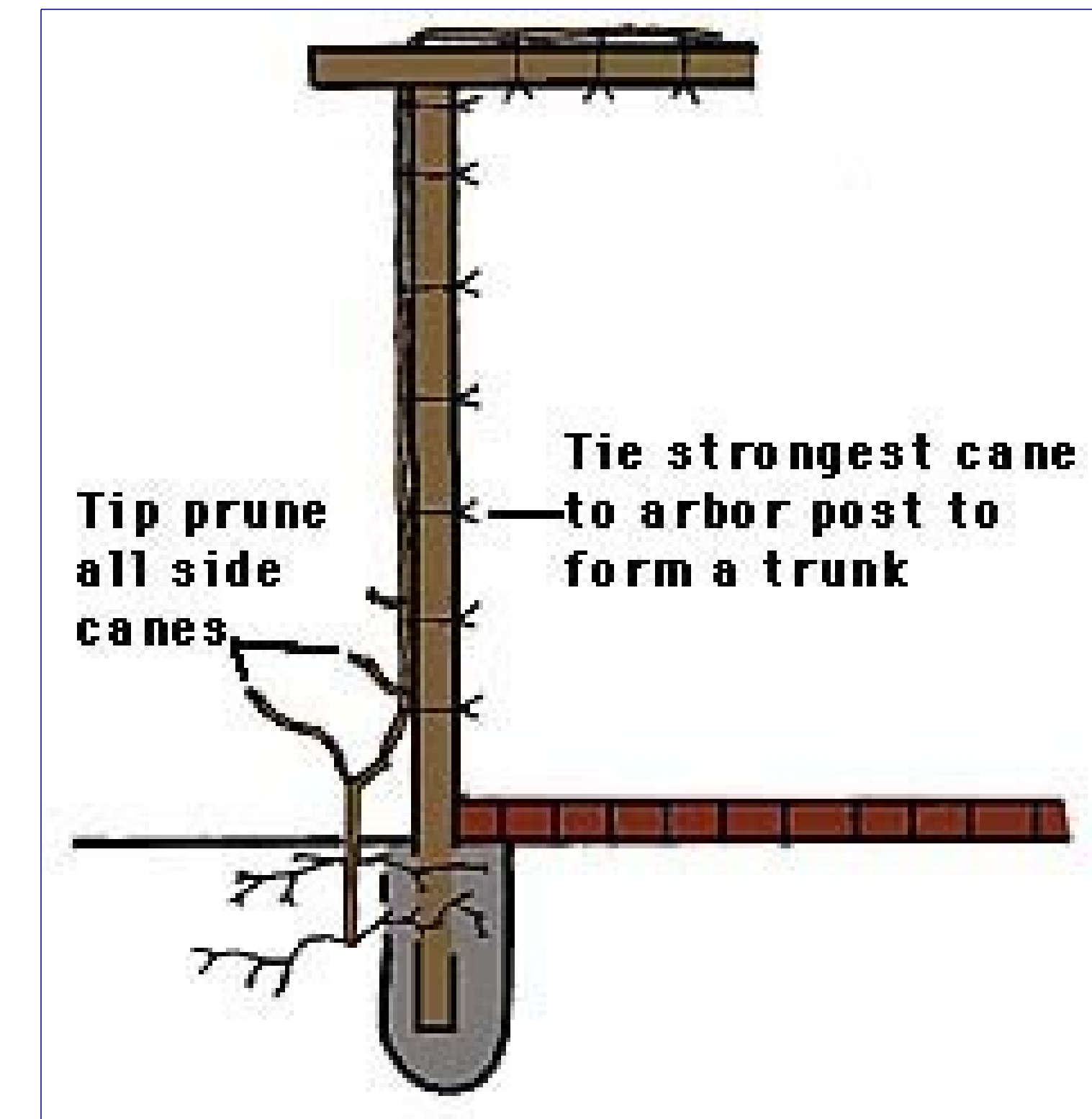

MODEL -

PLAN



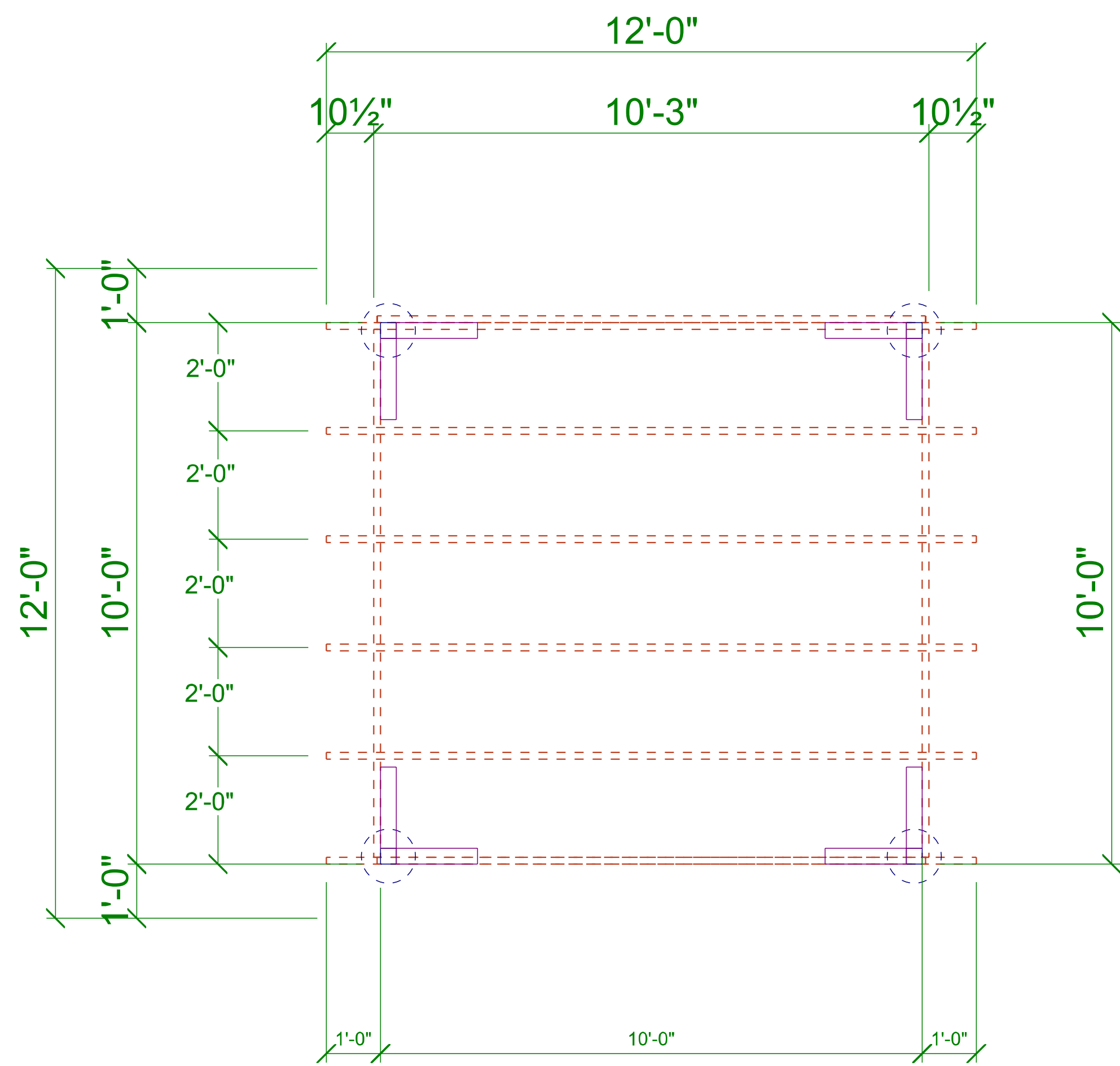

**Grape Arbor Frame**  
SCALE: 1/2" = 1'-0"

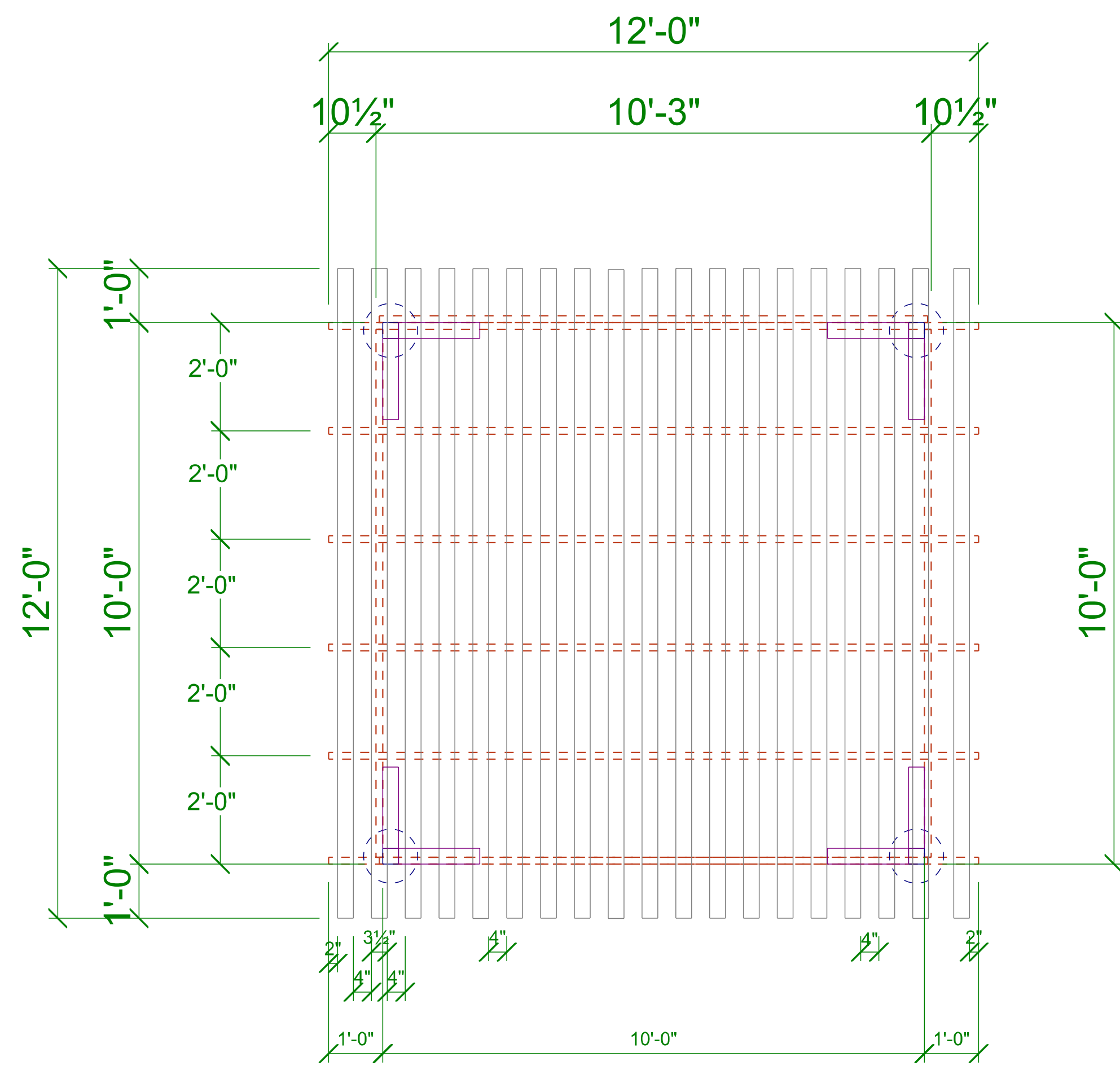

**Grape Arbor - Slats**  
SCALE: 1/2" = 1'-0"

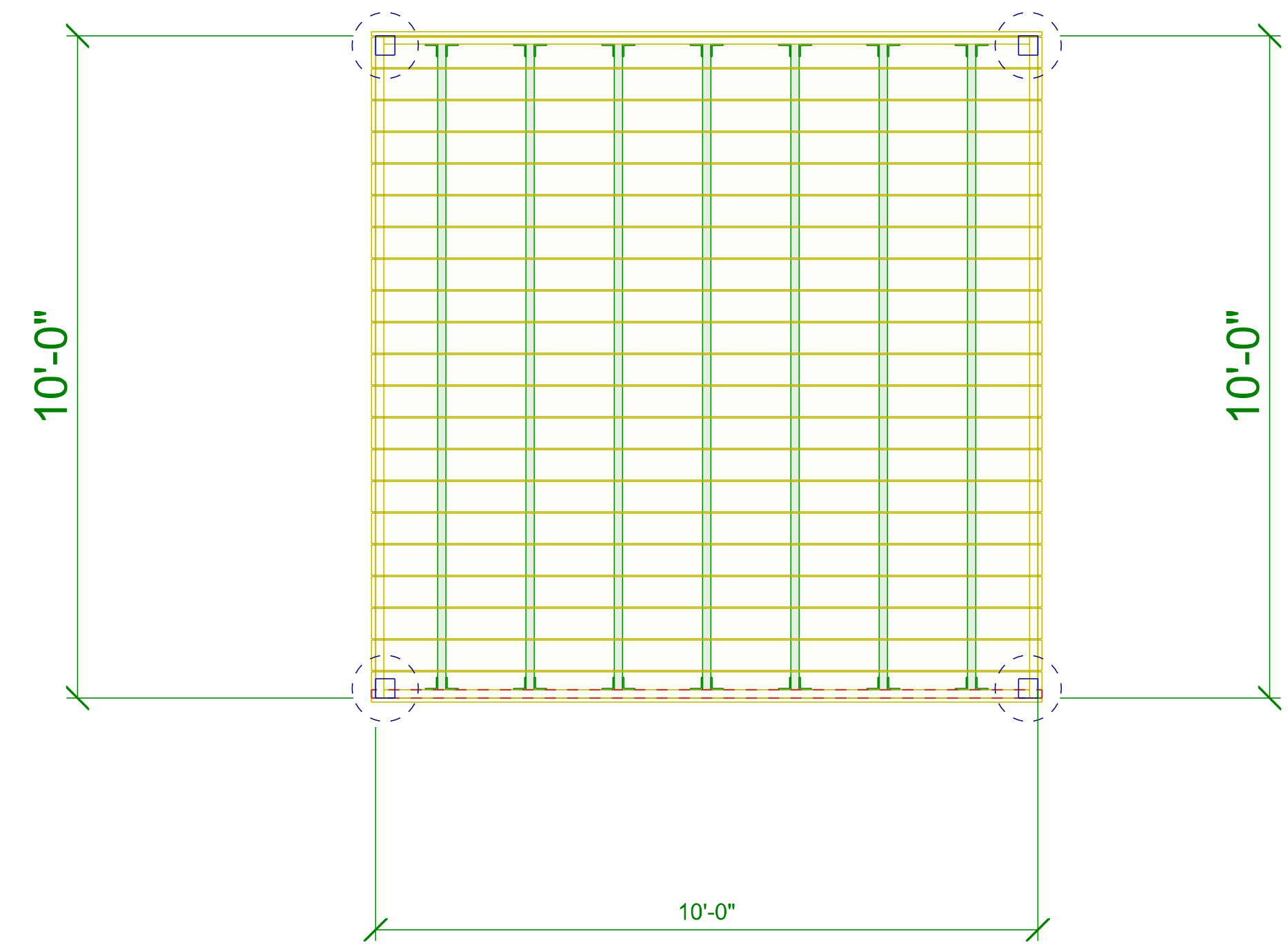

**Grape Arbor - Deck**  
SCALE: 1/2" = 1'-0"

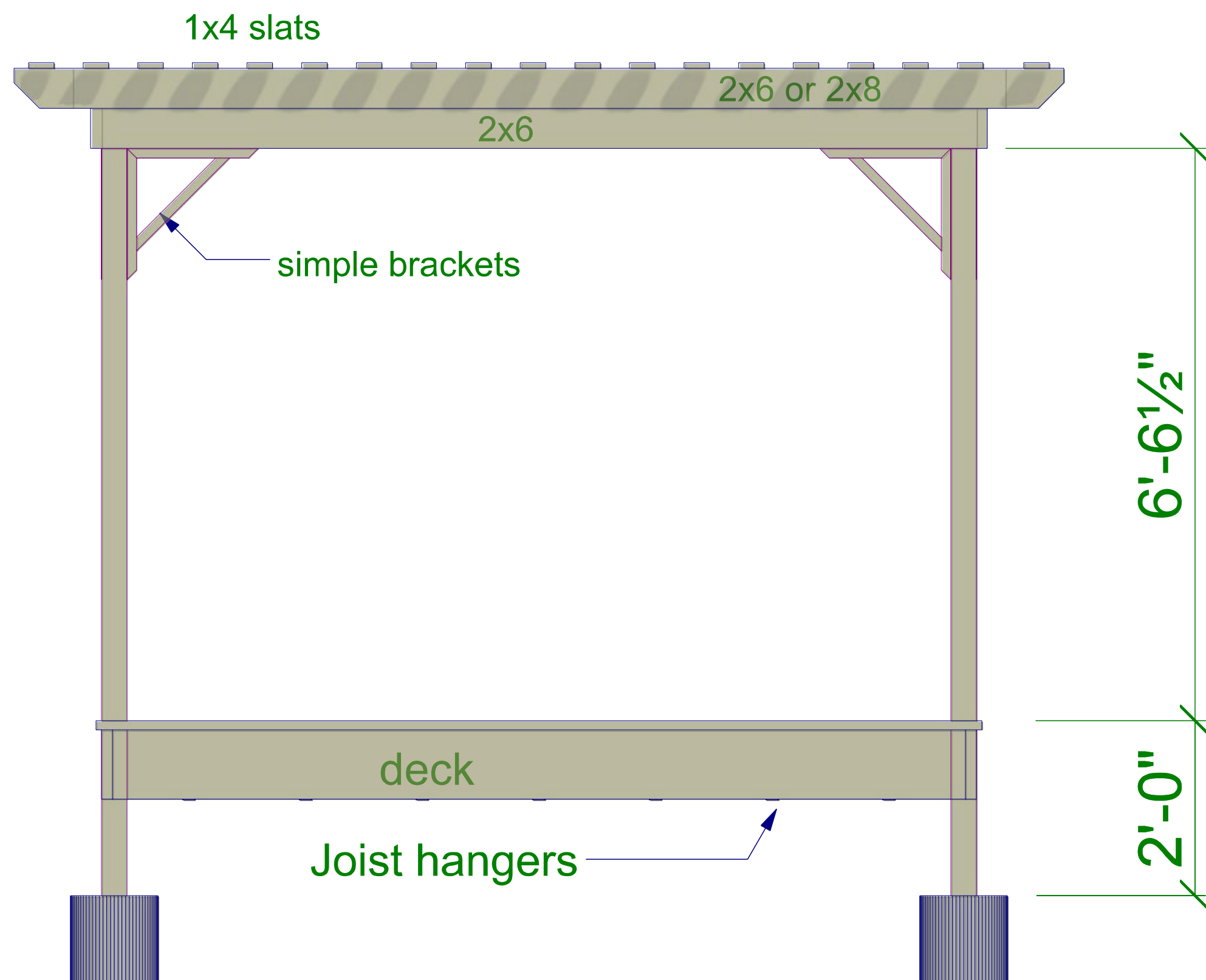

**SOUTH ELEVATION**  
SCALE: 3/4" = 1'-0"

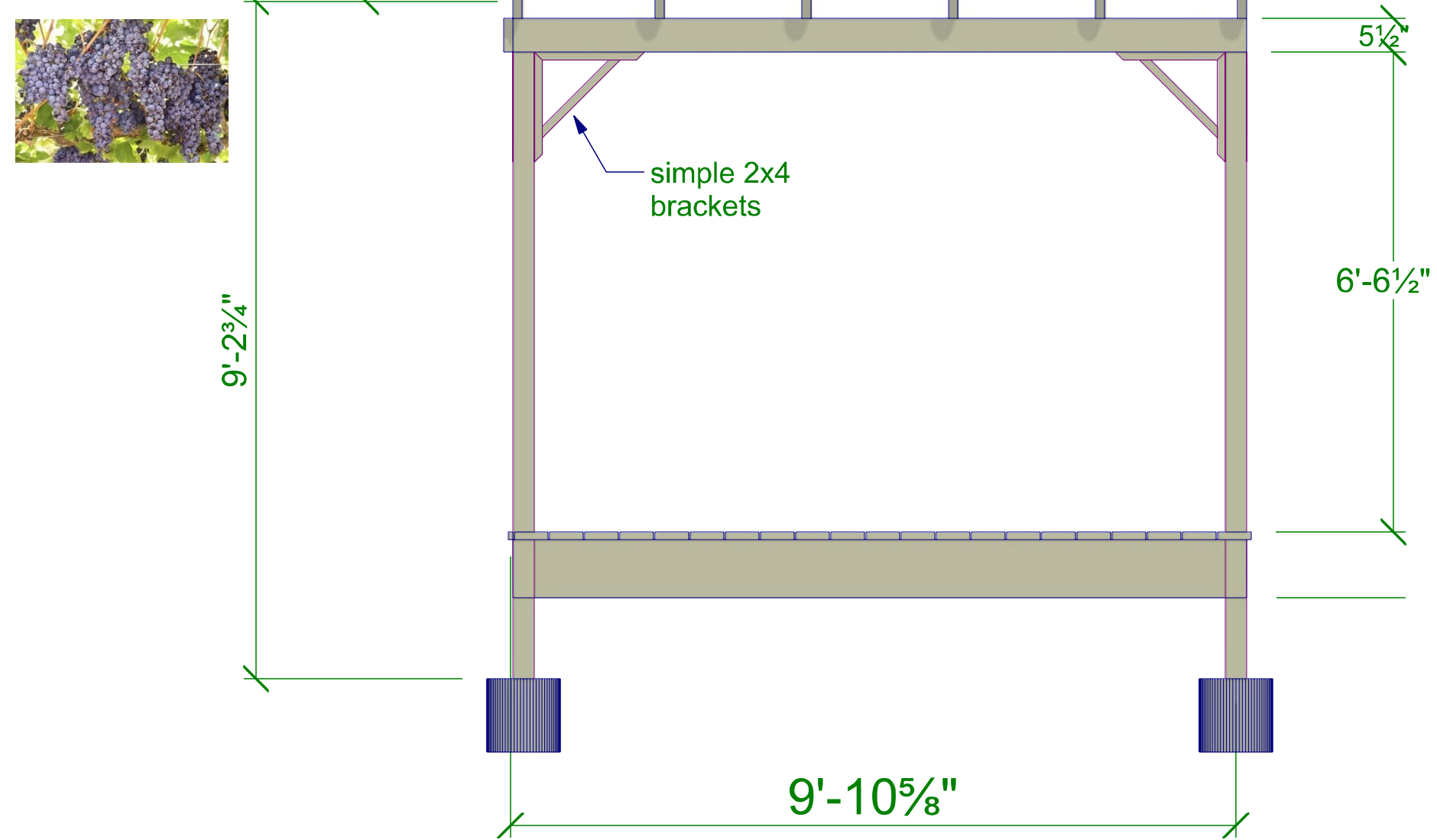

**WEST ELEVATION**  
SCALE: 1/2" = 1'-0"

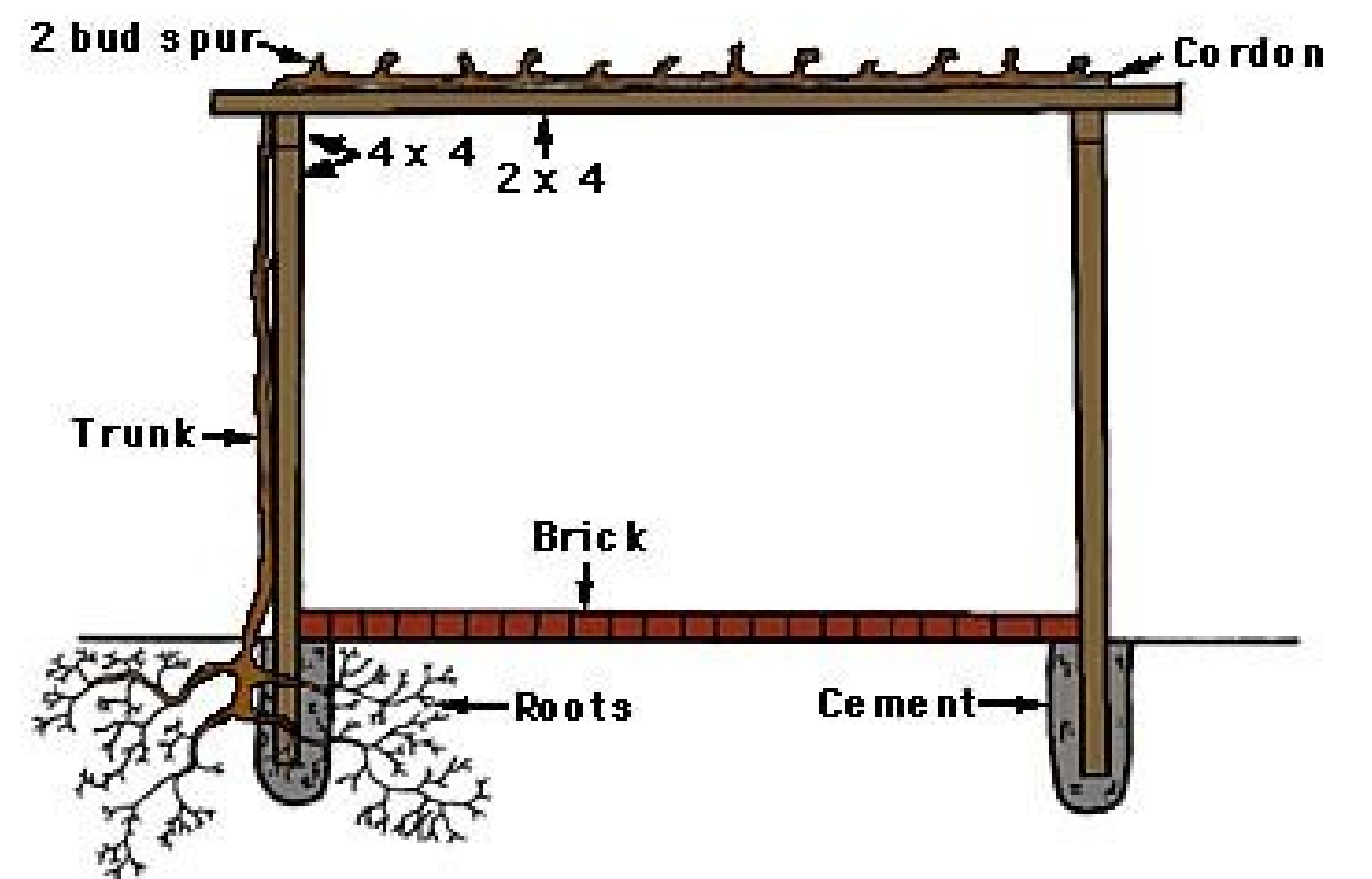

**Figure 4. An end view of a grape arbor with a dormant mature vine pruned to an arbor cordon.**

MODEL -

PLAN

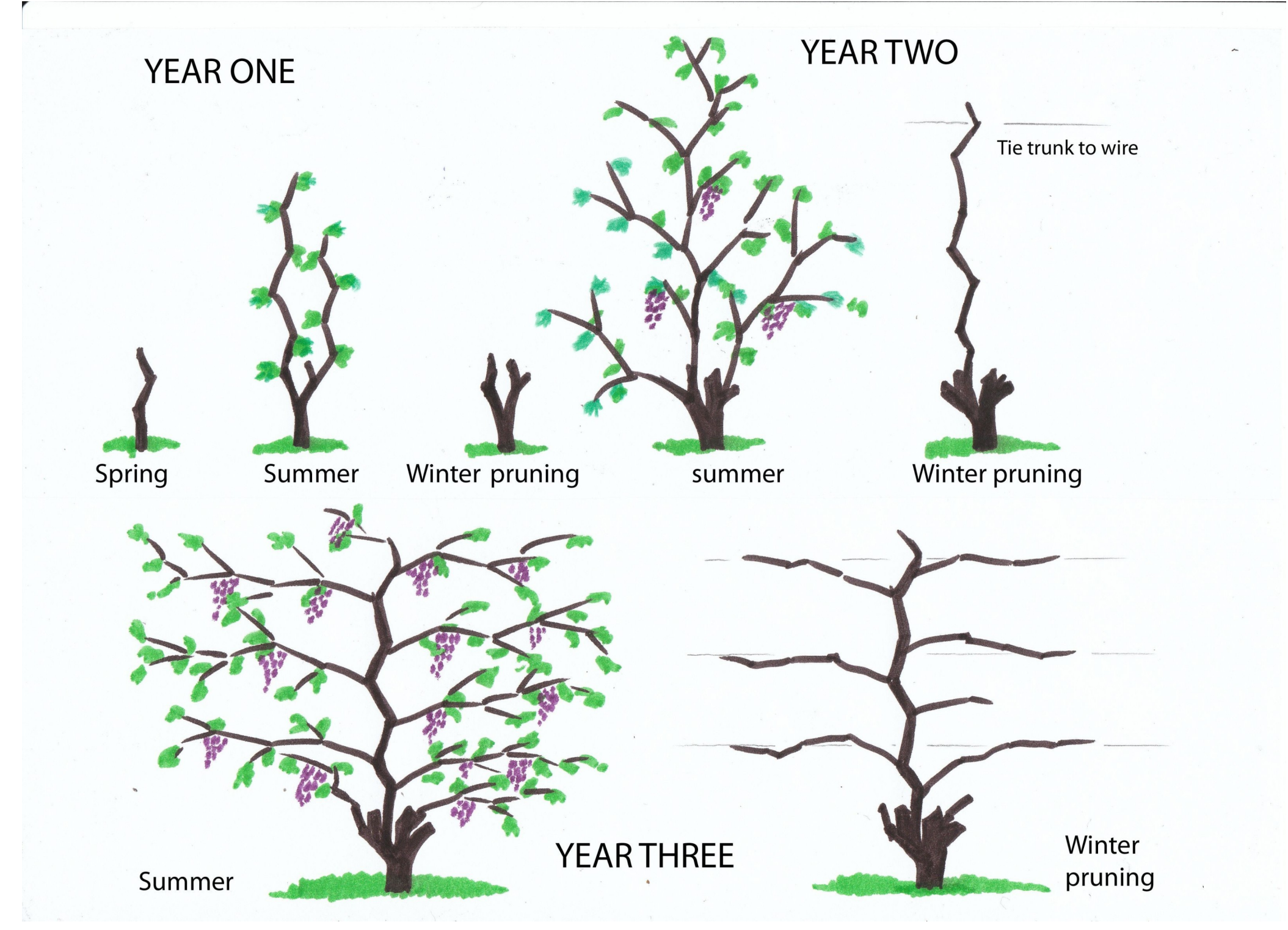
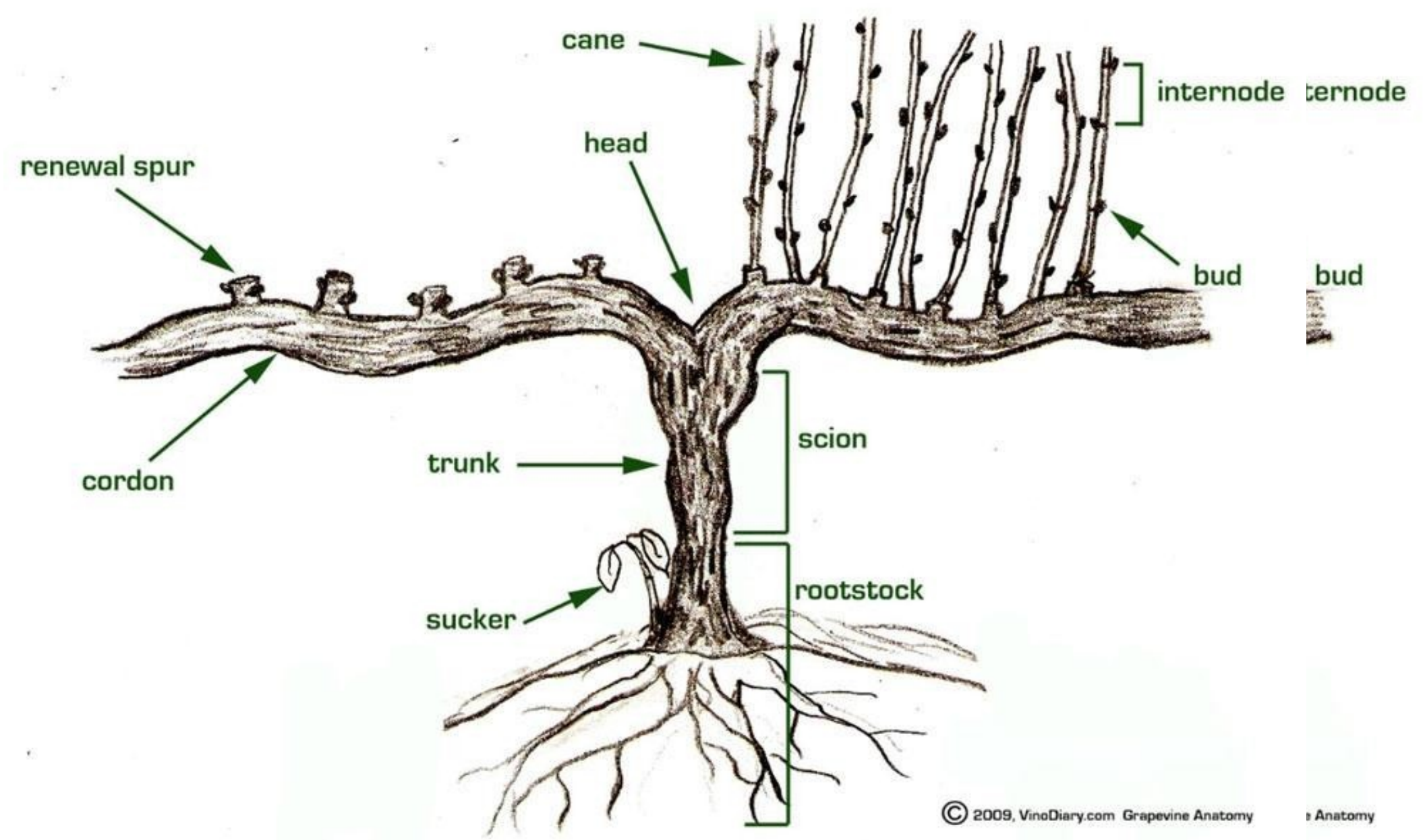
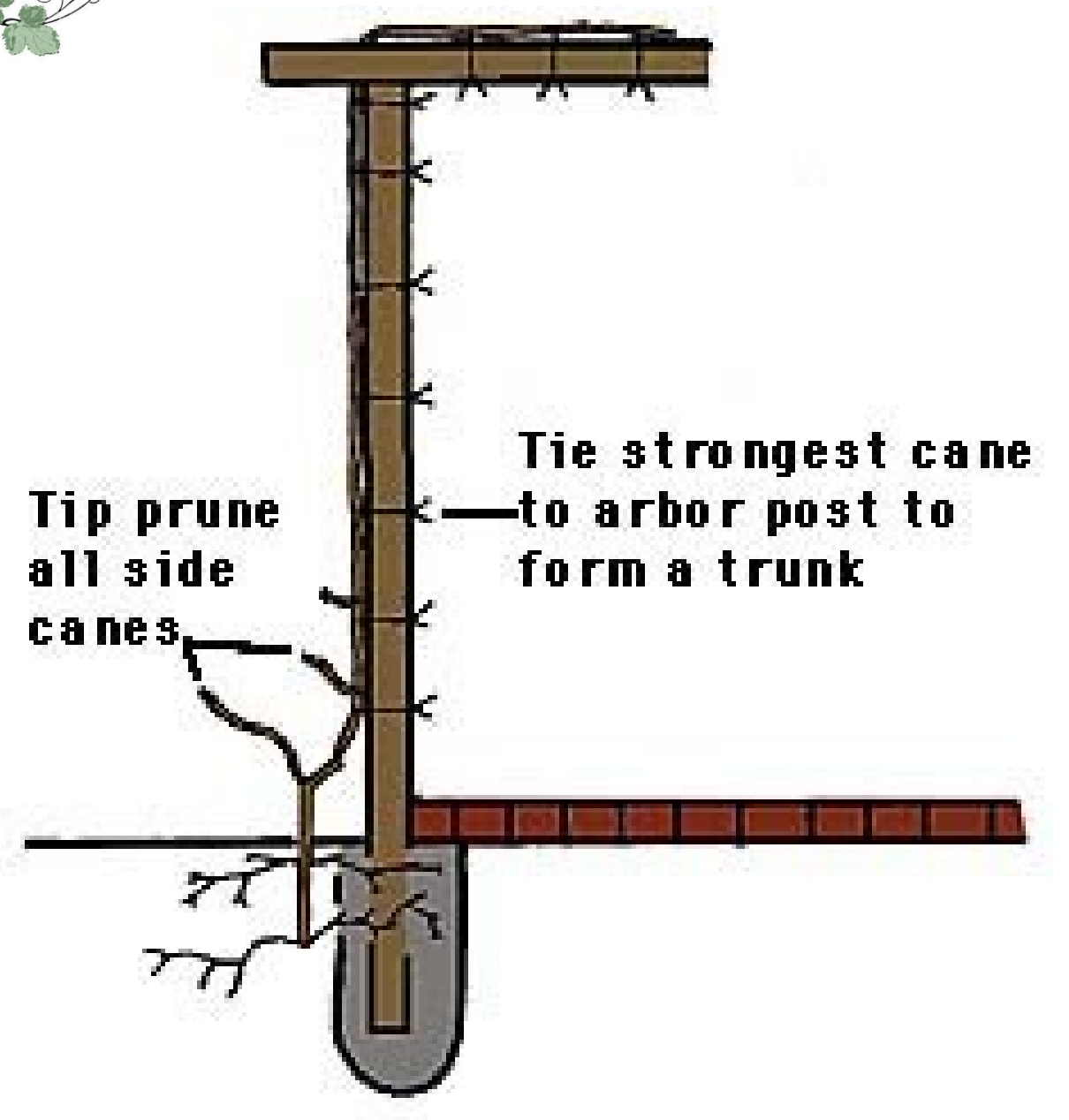

PAGE: 5/5  
 APPROVED: \_\_\_\_\_  
 CHECKED BY: \_\_\_\_\_  
 SECTION LETTER: A  
 PAGE NUMBERS: 11  
 SCALE: As Noted  
 DRAWN BY: bb  
 DATE: Sunday, March 15, 2026



MODEL - PLAN

Garden Irrigation Plan 2019 - 2220  
 PHONE: \_\_\_\_\_  
 FAX: \_\_\_\_\_  
 Bob Billings Design  
 706-878-8722